

Water Through Rail Shower

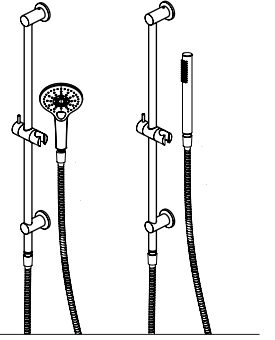

Anson Water Through Rail Shower & Edge Water Through Rail Shower

Please read these instructions in full before starting installation.

Important Safety Notes

Tapware must be installed by a licensed plumber in accordance with:

- Recommended working water supply pressure: 150-500 kPa
- Maximum hot water temperature – 75°C
- Australian standard AS3500.1 or relevant local authority requirements

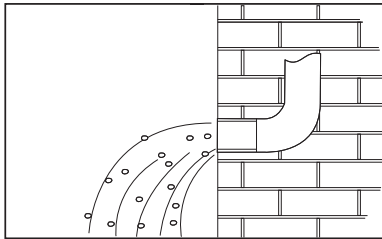

Before installation flush out all pipework and ensure it is clean and clear.

Ensure that the output pressure of cold and hot water meets the tap requirements.

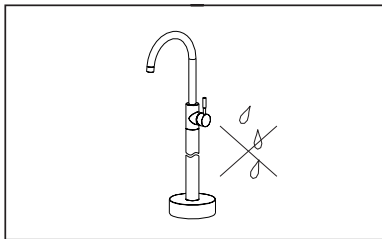

After installation, test all connections for leaks.

Care of your Tapware

This guide applies to all finishes. Clean your tapware with mild soap and warm water. Wipe the surface dry with a clean soft cloth.

Important

Avoid cleaners that contain chemicals such as ammonia, and chlorine, including citrus based and cream cleaners. These types of cleaning products could adversely affect the finish of the tapware and should not be used.

A

Fix teflon tape to wall outlet,
Drill hole on wall, as shown.

Apply teflon tape
to wall outlet.

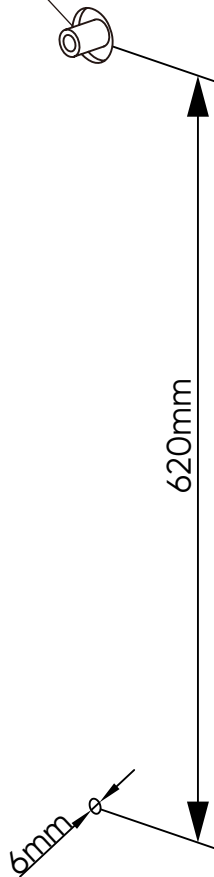

B

Put Flange to wall outlet, screw
adaptor on wall outlet.
The plastic plug is inserted into the
drilled hole, and then the Flange
and fixing joint are locked with
screws

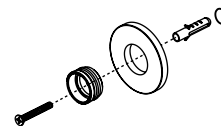
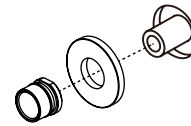

C

Press the slide assembly into the joint and Grub Screw to secure shower rail.

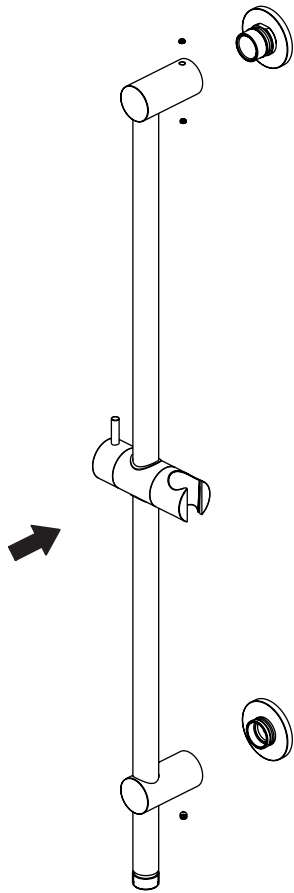

D

Attach shower hose & Handshower.

