

Modia Floor Mount Toilet Suite

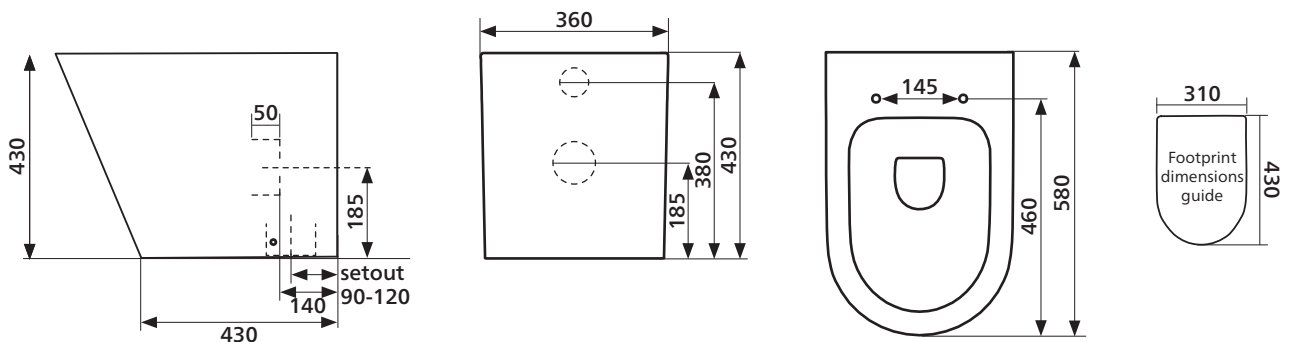

Important !

- 1 Inspect the components before installation to ensure there are no visible defects. If a defect is found, do not install the toilet suite and contact the supplier immediately. Claims for defects will not be accepted after the product has been installed.
- 2 Universal trap: Suitable for S-trap or P-trap installation (P-trap connector not supplied).
- 3 Must be installed by a licensed plumber in accordance with Australian Standard AS3500 and meet the requirements of local licensing authorities. Failure to do so may void the warranty.



Package contents

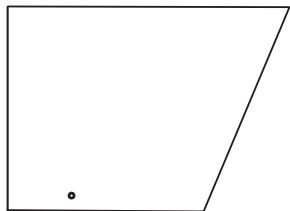

1 x ceramic pan

Threaded section can be trimmed to required size.

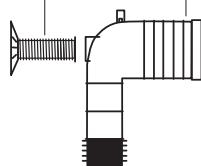

1 x pan connector
For connecting pan to floor outlet pipe/S-trap.
1 x threaded section (with flange plate)
Flange attaches to wall; threaded section links to pan connector.

Large end of pan connector can be trimmed to suit setout.

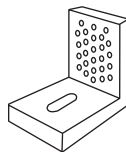

2 x concealed fixing brackets
Optional – can be used to connect pan to floor.

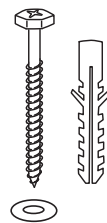

2 x floor bolts (and white plugs)
2 x washers
Optional fixing #2 – used with fixing brackets to secure pan to floor. Bolt is inserted through bracket base hole.



2 x caps
2 x screws
2 x pan plugs
Optional fixing #2 – used to secure pan to concealed fixing bracket. Plastic plug is placed into hole in side of pan exterior, screw is rebated into plug and then screws into a hole in upright section of bracket. Cap is used to cover plastic plug.

SEIMA

kitchen + laundry + bathroom ware

seima.com.au

Please note

- Installation shall be in accordance with AS/NZS3500.
- All measurements are in millimetres. Height dimensions are to base of pan. Make allowance for bedding.
- Bedding: Pan may be bedded with cement base or using silicone sealant. Fix pan to floor using a sand cement mixture of 3:1 to a depth of 60mm. Do not use lime or fast-drying cement.
- Bracket fixing: The pan should be bedded with silicone sealant and fixed with the brackets supplied.

- Do NOT use epoxy type adhesives.
- Dimensions are nominal and subject to normal ceramic manufacturing variations.
- Specifications may vary without notice as part of our continuous improvement practices.
- Clean with a damp cloth. Do not use abrasive cleaners, liquids or pastes.

Modia Floor Toilet Suite / 2

Modia Floor Mount pan and 100 cistern – Standard wall

Floor Mount installation with 100 slim cistern – 80mm thick

The 100 cistern can be installed within a standard wall, allowing for a cistern thickness of 80 mm. The flush button plate is placed on the wall above the toilet pan (front access). The cistern can be serviced through the flush plate. The 100 cistern can also be used in a nib wall.

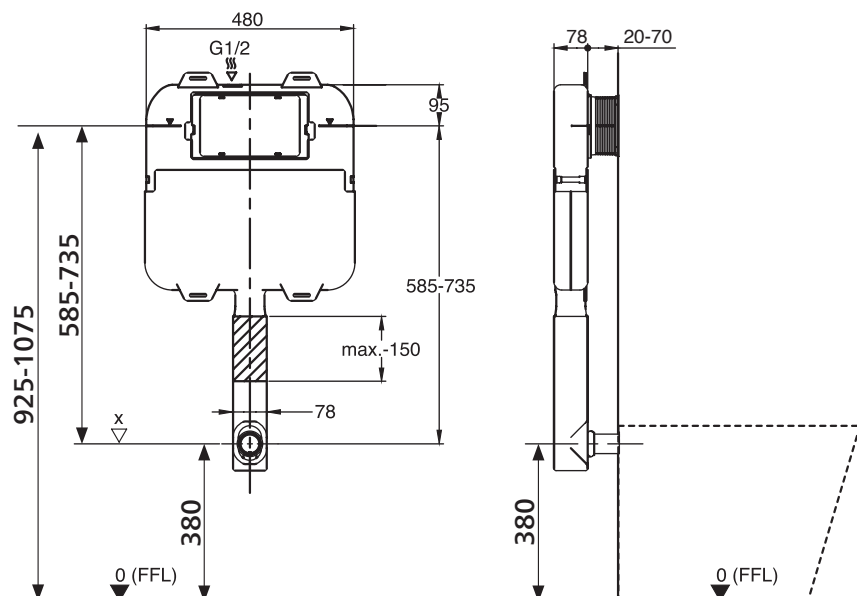
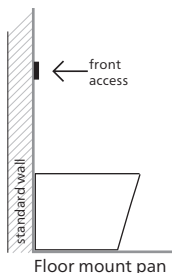

Modia Floor Mount pan and 101 cistern – Nib wall

Floor Mount installation with 101 cistern – 130mm thick

The 101 cistern can be installed within a nib wall, allowing for a cistern thickness of 130 mm. The flush button plate is placed either on the wall above the toilet pan (for front access) OR on the top of the nib wall (for top access).

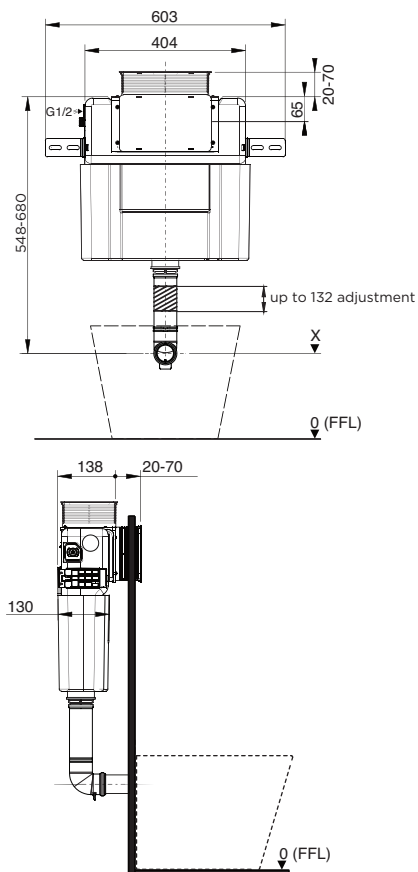
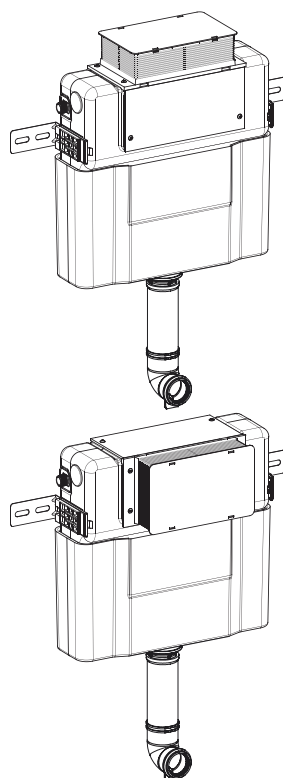
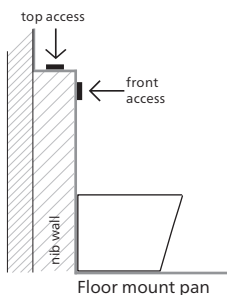

Modia Floor Toilet Suite / 3

1 S-trap procedure – Securing the pan connector in place

Determine the centre of the **pan** and mark the centre line on the floor and wall.

Work out the setout required for your specific site installation.

Setout range: 90–120.

You may need to trim the large end of the plastic **pan connector** to fit the required setout. To trim, first remove the plastic ring and rubber seal, then cut pipe to size. Refit rubber seal and plastic ring securely, ensuring a good fit.

Position the pan connector into the floor outlet pipe (S-trap). **Height measurement from the floor to the centre of the pan connector: 185mm.**

Slot the **threaded section (with flange plate)** onto the pan connector, ensuring that the flange plate is touching the wall. You may need to trim the threaded section so that it fits properly.

Mark and drill the flange plate holes and secure the plate to the wall with fixing screws. The pan connector is now installed.

2 Positioning the pan

Use the centre line marked on the wall and floor to position the **pan**. Push the pan into the installed plastic pan connector. It is recommended that wedges are used to support the foot of the pan during positioning.

3 Securing the pan on the floor

Cement fixing (Optional fixing #1)

If using cement bedding, level the pan while the cement mixture is workable. Fix pan to floor using a sand cement mixture of 3:1 to a depth of 60mm. Do not use lime or fast-drying cement.

Important: Allow at least 24 hours for the cement mixture to set before using the toilet.

Bracket fixing (Optional fixing #2)

Bed the pan with acetic cured silicone sealant, ensuring that the pan is level. Then position the concealed fixing brackets in line with the bracket fixing holes. Screw the floor bolts in place through the base of the brackets. Then secure the pan to the brackets using the plastic **pan plugs** and rebated **screws**. The **caps** can be used to cover the plugs on each side of the pan.

Important: Do not over-tighten the bolts or screws as this may cause the ceramic to crack and break.

4 Seat package contents

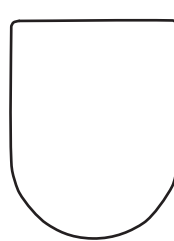

1 x seat and lid
Has receptor holes that slide onto stainless steel pins.

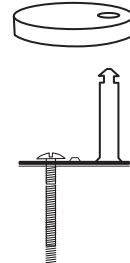

2 x stainless steel caps
(used to cover stainless steel plate w pin)

2 x stainless steel plates with pin
(seat locates onto stainless steel pins)

2 x metal bolts
(used for securing stainless steel plate and pin to pan)

5 Seat installation

Secure the toggle bolts into the seat connection holes, ensuring that the stainless steel pins line up with the receptor holes in the seat. Once correctly placed, ensure that the bolts are properly tightened.

Slide the stainless steel caps onto the plates with pins.

To fit the seat, slide it onto the stainless steel pins. You may need to make adjustments to position the seat correctly.

To release the seat, put the seat in an upright position, press the buttons on the seat and lift upwards.

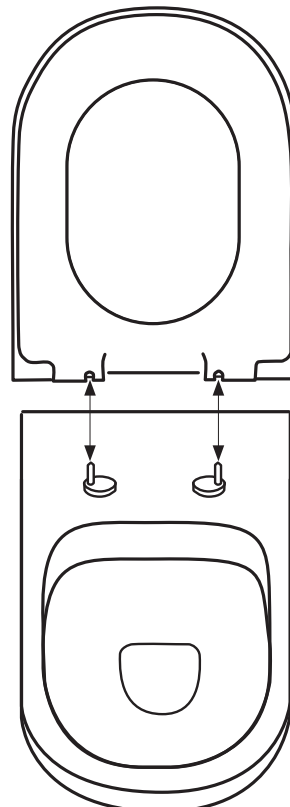

To fit seat, slide seat down onto stainless steel pins.

To remove seat, put seat in upright position, press the buttons on the seat and lift upwards.