

Designer Sink Mixers

- Anson Pullout / Avida Pullout / Jorji Pullout Sink Mixers
- Anson / Avida Sink Mixers

Please read these instructions in full before starting installation.

Important Safety Notes

Tapware must be installed by a licensed plumber in accordance with:

- Recommended working water supply pressure: 150–500 kPa
- Maximum hot water temperature – 75°C
- Australian standard AS3500.1 or relevant local authority requirements

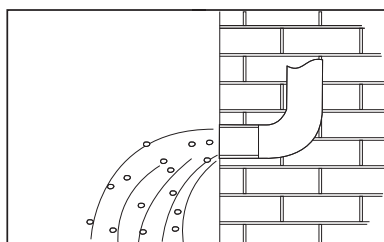

Before installation flush out all pipework and ensure it is clean and clear.

Ensure that the output pressure of cold and hot water meets the tap requirements.

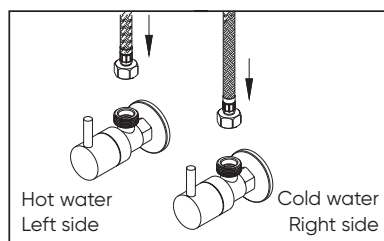

Connect the stainless steel braided hose to the valves, ensuring that the hot water port is on the left valve and the cold water port is on the right valve.

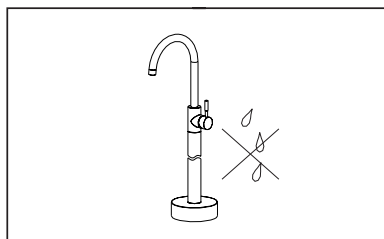

After installation, test all connections for leaks.

Care of your Tapware

This guide applies to all finishes. Clean your tapware with mild soap and warm water. Wipe the surface dry with a clean soft cloth.

Important

Avoid cleaners that contain chemicals such as ammonia, and chlorine, including citrus based and cream cleaners. These types of cleaning products could adversely affect the finish of the tapware and should not be used.

Installation Instructions for

Anson + Avida + Jorji Pullout Spray Sink Mixers

These installation instructions are for the following:

- Anson Pullout Spray Sink Mixer
- Avida Pullout Spray Sink Mixer
- Jorji Pullout Spray Sink Mixer

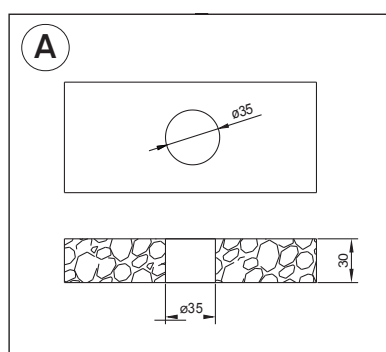
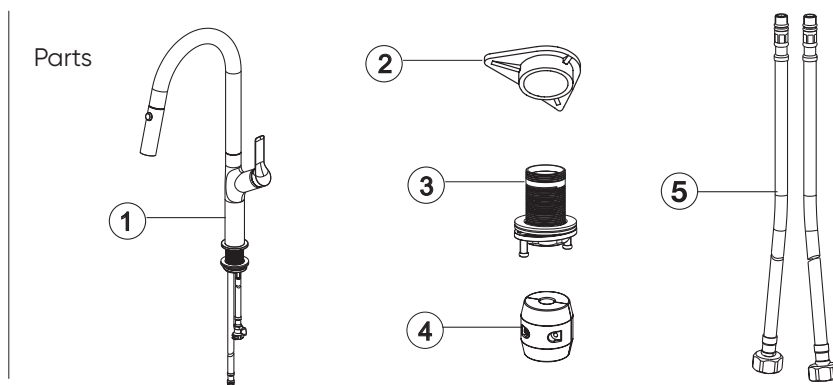

Cut a 35mm diameter hole in the appropriate location of the benchtop or sink where the mixer tap is to be mounted.

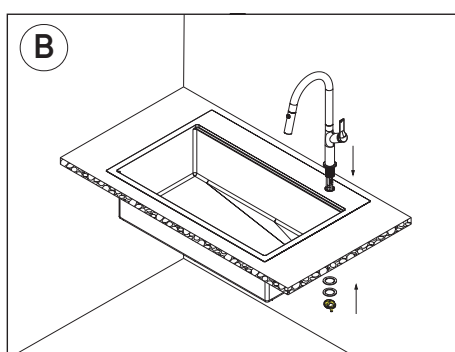

Remove the bottom mounting parts from the main unit in order. Then insert the body unit into the mounting hole and adjust it to the proper position. (White plastic triangle spacer and gaskets should be used on the base/body in contact with bench or sink surface.) Then put on the rubber gasket, stainless steel gasket and nut.

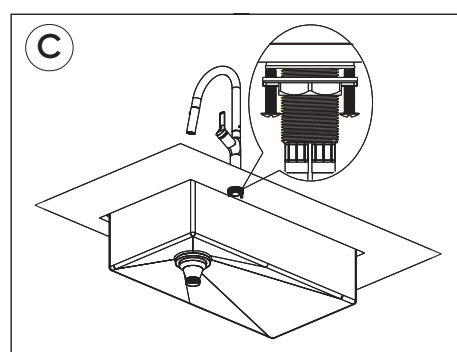

Lock the mixer tap with the nut in a clockwise direction when adjusting the tap position to fix the tap on the benchtop or sink surface.

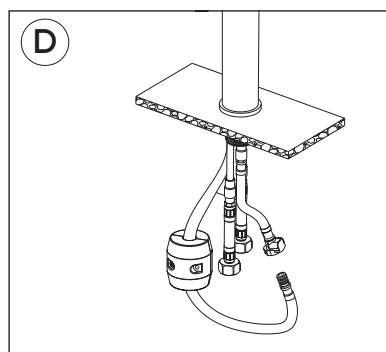

Set the counterweight ball on the appropriate position of the pullout hose. Lock the screw tightly, and then insert the pullout hose on the push-fit adaptor (quick connector) of the short pipe.

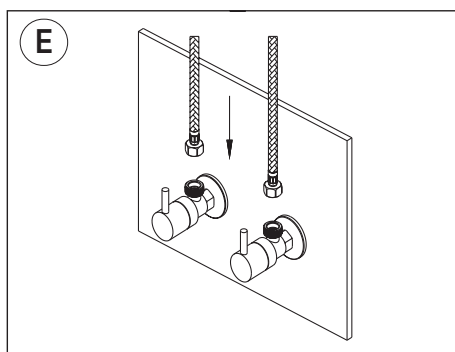

Tighten the water inlet braid on the water supply valves separately.

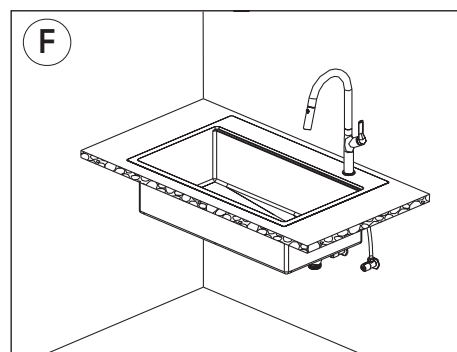

Make sure that all connections are tightened, open the drain, turn on the main water supply, and check for leaks in all parts of the tap assembly.

Installation Instructions for Anson + Avida Sink Mixers

These installation instructions are for the following:

- Anson Gooseneck Sink Mixer
- Anson Squareline Sink Mixer
- Avida Sink Mixer

Parts

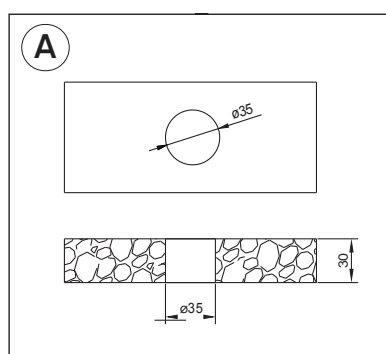
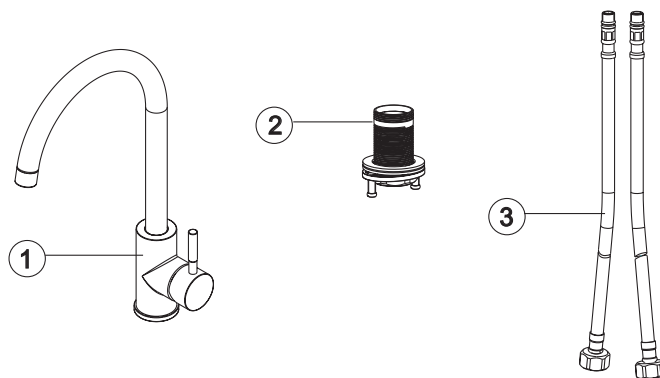

Cut a 35mm diameter hole in the appropriate location of the benchtop or sink where the faucet is to be mounted.

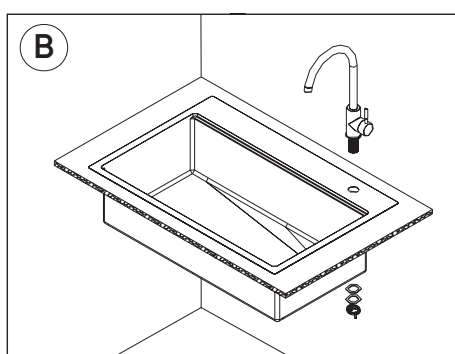

Remove the bottom mounting parts from the main unit in order. Then insert the body unit into the mounting hole and adjust it to the proper position. (Gaskets should be used on the base/body in contact with bench or sink surface.) Then put on the rubber gasket, stainless steel gasket and nut.

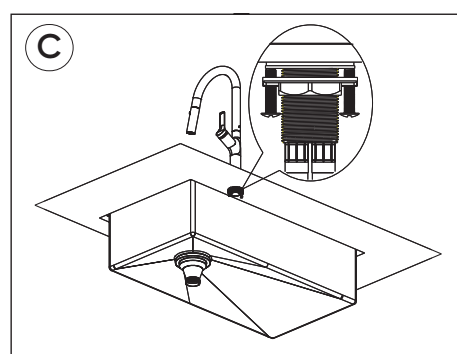

Lock the mixer tap with the nut in a clockwise direction when adjusting the tap position to fix the tap on the benchtop or sink surface.

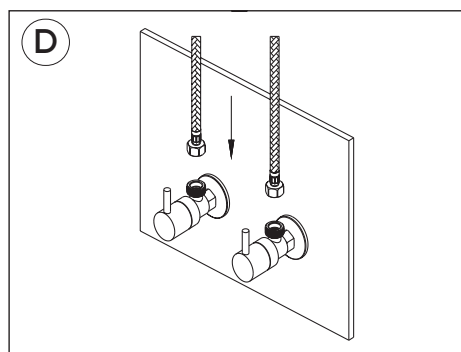

Tighten the water inlet braid on the water supply valves separately.

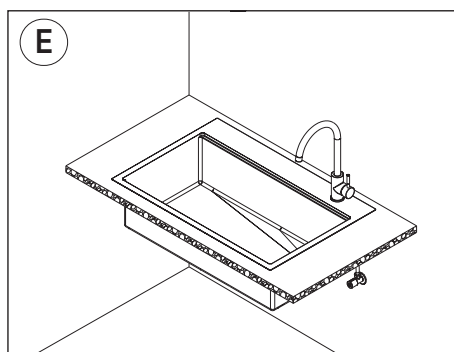

Make sure that all connections are tightened, open the drain, turn on the main water supply, and check for leaks in all parts of the tap assembly.